

Silhouette Cutting Machine
Supplies Manual

Power Engraver

MANUAL NO. CURIO-TOOL-EGV-M-151

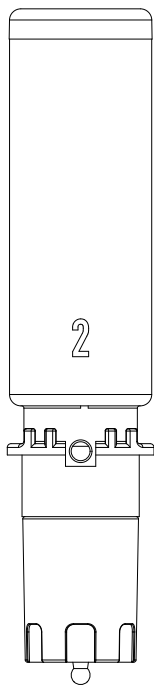

To ensure safe use

⚠ CAUTION

- Please read this manual carefully in advance to use the product safely and correctly.
- The precautions listed in this manual are important for your safety. Always observe these precautions.

Precautions for Use

- For instructions on how to use the cutting machine, refer to the User's Manual for the machine's main unit.
- Do not touch the main unit or tools during operation.
- When using light-reflecting media, if the media height cannot be read, press the "Thickness Detection Button" when the tool carriage is on top of the masking tape holding the media in place to set the height of the media.
- When using the Power Engraver tool, use the "Dust Tray" to prevent dust from accumulating in the Y-bar rail grooves.
- Cut scraps can fly out of the machine during engraving processing. Keep your face away from the machine during processing.
- After media processing, remove the entire CURIO2 dust tray to ensure that no cut scraps fall onto the main unit.
- The media and tool setting methods vary depending on the model you use. See the main unit's User's Manual for details.
- The contents of the Supplies Manual are subject to change without notice.

About Power Engraver

The following item (sold separately) are required for Power Engraver processing:

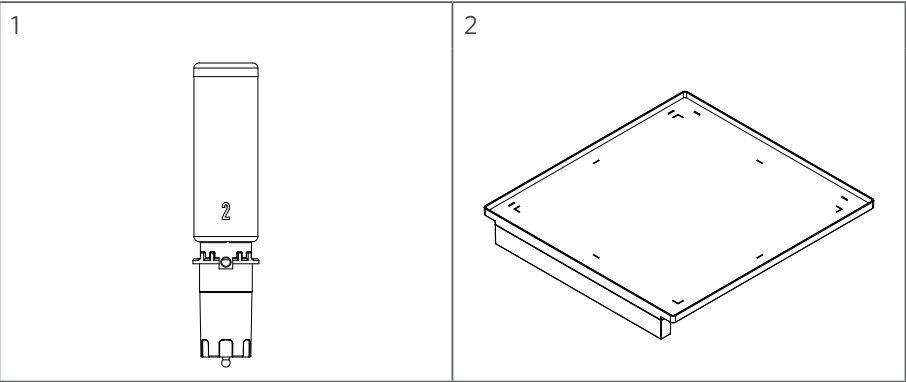

	Product Name	Model Number	Contents
1	Power Engraver ^{*1}	CURIO-TOOL-EGV	1 pc., Tip size: 2.5 mm
2	CURIO2 Dust Tray	CURIO-DEBRIS-TRAY	1 pc., 12 in. x 12 in. (305 mm x 305 mm)

^{*1}: If you purchased the Power Engraver without its accessories, you need to purchase the "CURIO2 Dust Tray" which is sold separately.

Overview

The Power Engraver can engrave materials such as acrylic plates by cutting them. It can be used for metal etching, and aluminum plates, acrylic, and balsa (not authentic) can be used as media materials.

Supported model

CURIO2

How to set media and install tools

- 1 Remove the CURIO2 replacement electrostatic table and install the CURIO2 dust tray.
 - To change the tray, first slide the clips to the left and right sides of the tray away from the CURIO2 main unit, then pull the CURIO2 replacement electrostatic table to slide it out.

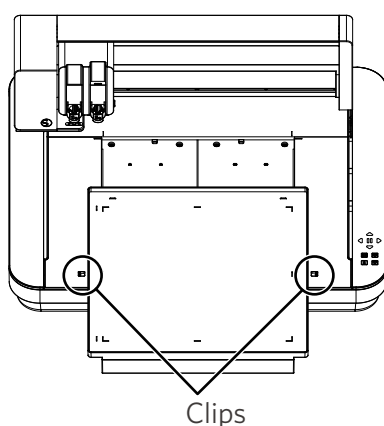

- 2 Secure the four sides of the media with masking tape.

Place the media within the area marked by the L shapes at the 4 corners of the CURIO2 dust tray.

 - The area inside of the four corners is the drawing area.

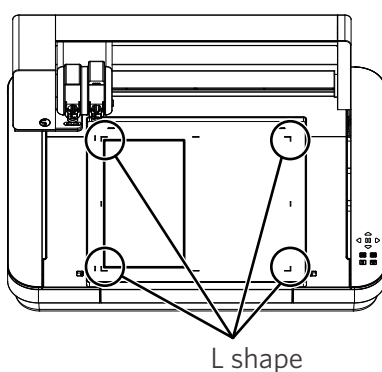

- 3 Align the ribs of the Engraver Tool with the notches of Tool Holder 2 and insert the Engraver Tool firmly into Tool Holder 2 before pushing the lock lever back to lock the parts into place.

- Be sure to set the engraver tool onto Tool Holder 2.

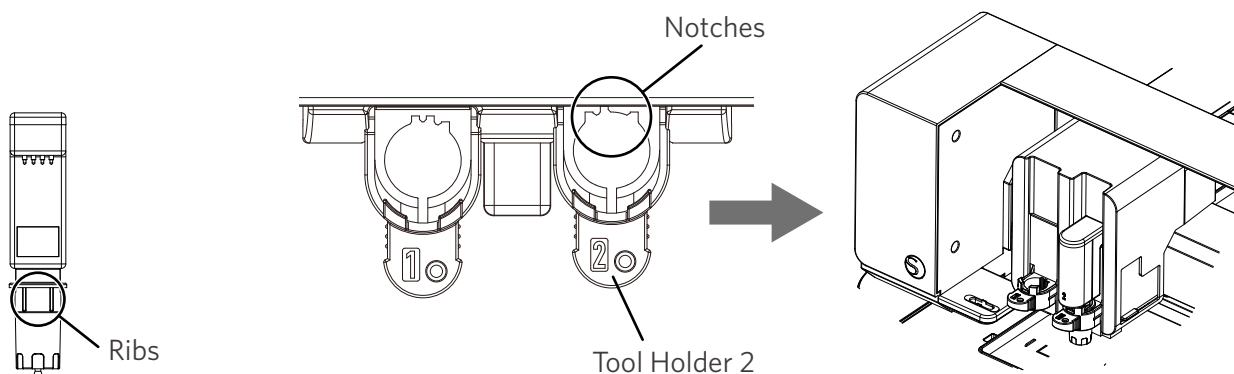

CAUTION

Cut scraps can fly out of the machine during engraving processing. Keep your face away from the machine during engraving.

When test-cutting

- 1 Click the "Test" button when you have finished setting the cutting conditions.
The rectangle and triangle test patterns are engraved.
- 2 When the test cutting is finished, check the media to see if it is cleanly engraved.
- 3 If the media was not engraved well, readjust the cutting conditions.

Note

Try readjusting the conditions and repeat the test-cutting until you find the optimum cutting conditions for the media you want to use.