

Silhouette Cutting Machine  
Supplies Manual

# Leather Punch

MANUAL NO. CURIO-TOOL-PUNCH-M-151

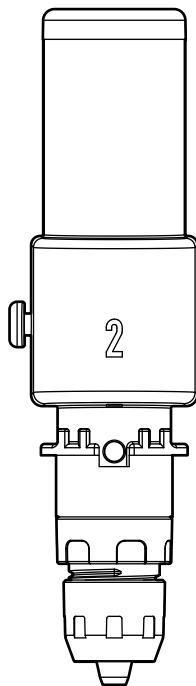

## To ensure safe use

### CAUTION

- Please read this manual carefully in advance to use the product safely and correctly.
- The precautions listed in this manual are important for your safety. Always observe these precautions.

## Precautions for Use

- For instructions on how to use the cutting machine, refer to the User's Manual for the machine's main unit.
- The blade on the machine is rotating during the punching process. Keep your hands and face away from the machine during the punching process.
- Depending on the thickness and hardness of the leather, it may not be possible to cut through it.
- The media and tool setting methods vary depending on the model you use. For more details, please refer to the User's Manual for the main unit.
- The contents of the Supplies Manual are subject to change without notice.

# About Leather Punch

The following supplies are required to use the Leather Punch:

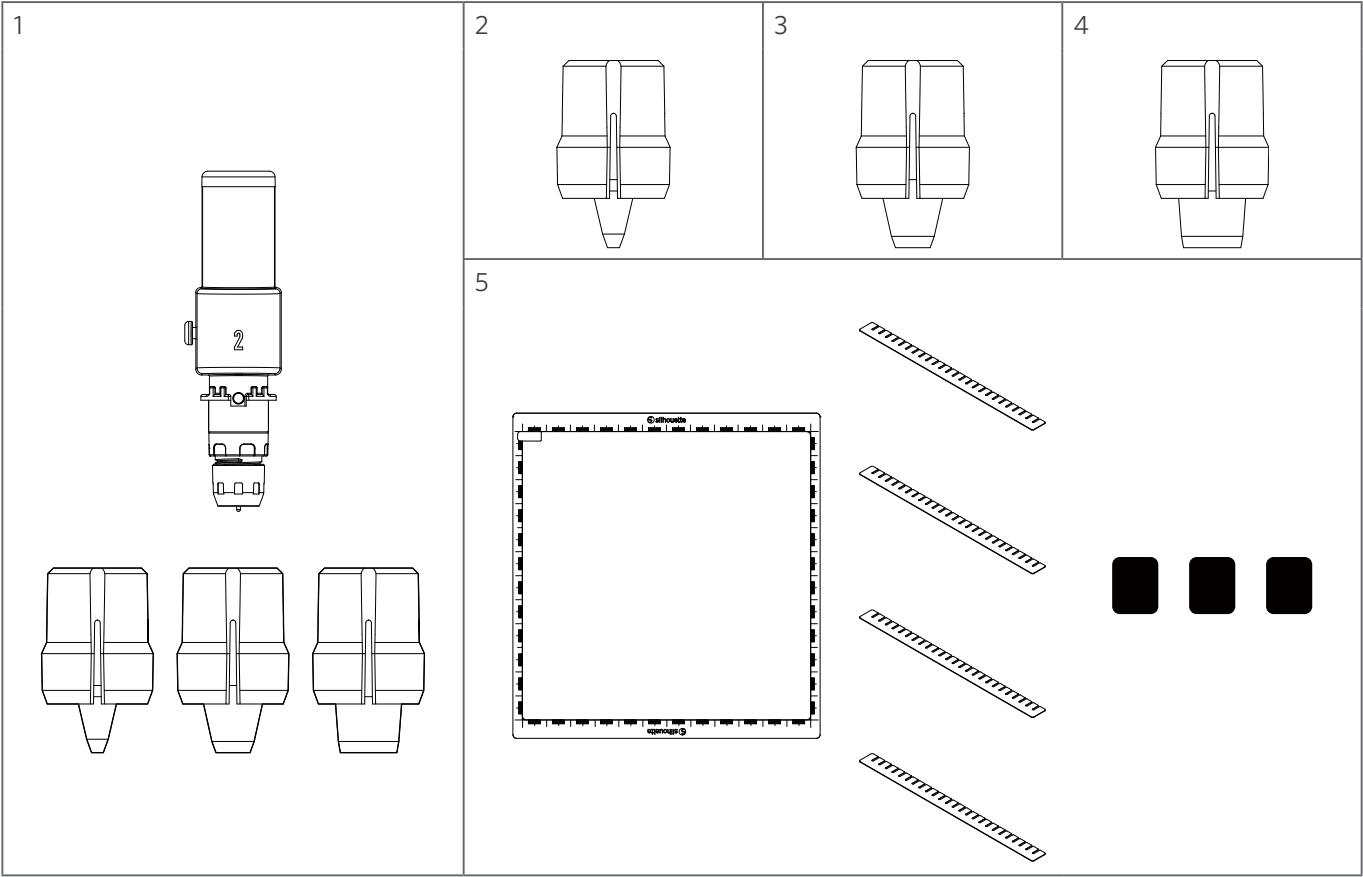

	Product Name	Model Number	Contents
1	Leather Punch Tool Set *1	CURIO-TOOL-PUNCH-SET	Leather Punch Tool, 1 pc. 1 pc., Leather Punch Tool Replacement Blade - 1 mm 1 pc., Leather Punch Tool Replacement Blade - 3 mm 1 pc., Leather Punch Tool Replacement Blade - 5 mm
2	Leather Punch Tool Replacement Blade - 1 mm	CURIO-TOOL-PUNCH-T1	3 pcs., Tip size: 1 mm
3	Leather Punch Tool Replacement Blade - 3 mm	CURIO-TOOL-PUNCH-T3	3 pcs., Tip size: 3 mm
4	Leather Punch Tool Replacement Blade - 5 mm	CURIO-TOOL-PUNCH-T5	3 pcs., Tip size: 5 mm
5	CURIO2 Embossing Mat	CURIO-EMBOSS-12-B	Embossing mat x1, 12 in. x 12 in. (305 mm x 305 mm) Media plate x4, registration-mark sheet x3

\*1: In order to use the Leather Punch, you need to purchase the "CURIO2 Embossing Mat" (sold separately).  
To purchase accessories sold separately, contact the retailer where you purchased this product.

## Overview

The Leather Punch is a tool that can punch holes in leather and synthetic leather.

## Supported model

CURIO2

## How to set media and install tools

- 1 Lay out the embossing mat. Next, place the leather onto the embossing mat with the smooth side down and fix it to the embossing mat.
- 2 Gently hold the media in place and use the electrostatic suction button to suction it and fix it in place with static electricity.
- 3 Attach the blade to the Leather Punch Tool.

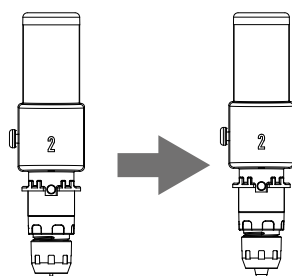

- 4 Align the ribs of the Leather Punch Tool with the notches of Tool Holder 2 and insert the Leather Punch Tool firmly into Tool Holder 2 before pushing the lock lever back to lock the parts into place.

### CAUTION

The blade on the machine is rotating during the punching process. Keep your hands and face away from the machine during the punching process.

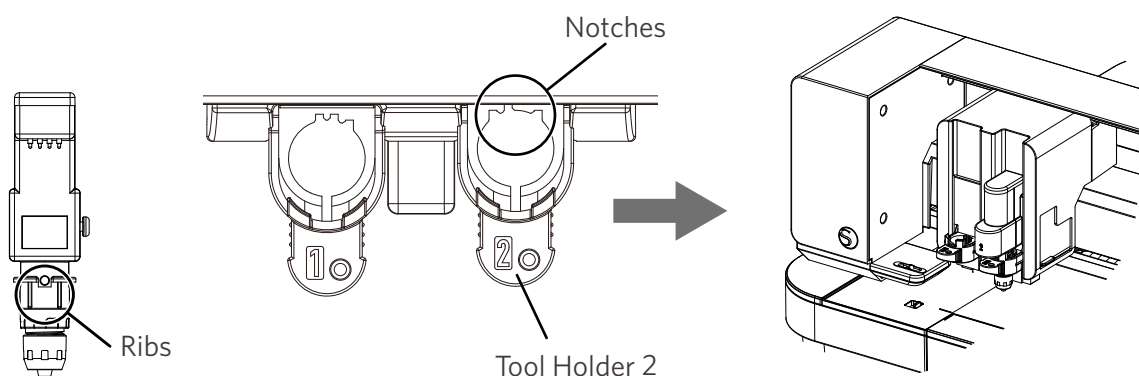

## How to replace replacement blade

The supplied replacement blade can be replaced with a blade size to suit the diameter of the hole you wish to punch (Ø1, 3, or 5 mm ). There are the following two ways to replace the blades:

<Replacement method using pin>

- 1 Twist the lower part of the Leather Punch Tool while holding down the pin.
- 2 Pull out the replacement blade.
- 3 Push the new replacement blade all the way into the Leather Punch Tool to set it into place and close the cap.
- 4 Twist the lower part of the Leather Punch Tool closed while holding down the pin.

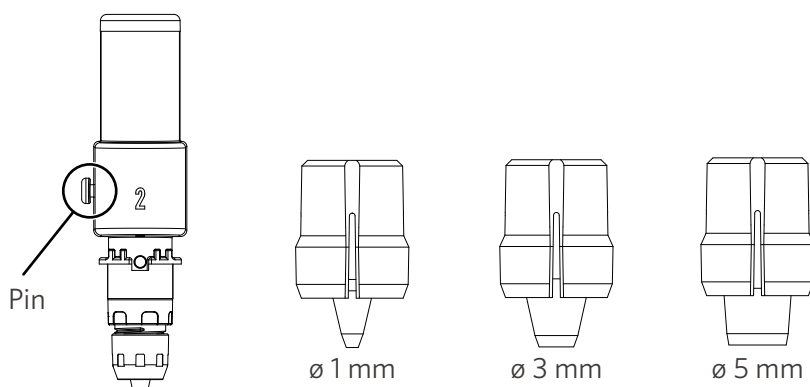

### Note

Because the tool does not come with a blade attached, follow the steps above to attach a replacement blade.

## &lt;Replacement method using hole&gt;

- 1 Insert a thin, rod-shaped object (with a diameter of 1 mm or smaller) through the hole, as shown in the figure below.

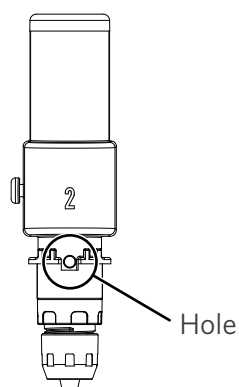

- 2 Remove the cap and pull out the replacement blade.
- 3 Push the new replacement blade all the way into the Leather Punch Tool to set it into place and close the cap.
- 4 Remove the thin, rod-shaped object you inserted in Step 1.

**⚠ CAUTION**

- When there are cut leather scraps caught inside the replacement blade, detach the back end of the blade from the tool to remove any cut scraps caught inside.

